



Cordless Lawn Mower DLM330 330 mm (13")



For small gardens



Mowing area
with BL1840B

270 m²



3 in 1 Cutting / Collecting / Mulching

Plastic Cutting Deck

allows for lightweight design to increase maneuverability in turns, preparation, storage and more.

Carrying handle



Rigid handle

Increased handle rigidity by adding a loop-shaped pipe

Handle height adjustment

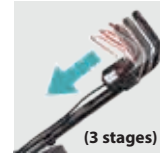

Grass catcher with grass level indicator



Easy-to-operate handle lock levers



Each side of the handle can be locked/unlocked with just a single action without tool.

Cutting width
330mm

Steel sleeve for holding rear wheel axle

Easier cutting height adjustment

8 stages(20 - 75 mm)

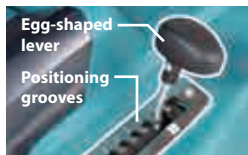

- Easy-to-grip egg-shaped lever.
- Positioning grooves for the lever can be visually confirmed.

2-tooth blade



for both mowing and mulching

Indication lamp



Indication lamp behind the motor for easy visibility

Vertical storage



Compact storage of grass catcher allows for space-saving vertical storage

XPT



IPX4-rated water-resistance

Accessories

Blade



Size: 330mm
Part No. GB00000042



Charging Time

		Fast Charging		
		DC18RC	DC18RD	DC18SD
	BL1815N 1.5Ah	15 min	30 min	30 min
	BL1820B 2.0Ah	24 min	45 min	45 min
	BL1830B 3.0Ah	22 min	60 min	60 min
	BL1840B 4.0Ah	36 min	90 min	90 min
	BL1850B 5.0Ah	45 min	110 min	110 min
	BL1860B 6.0Ah	55 min	130 min	130 min

Cordless Lawn Mower

DLM330 330 mm (13")

	Brake	Cutting Width	330 mm (13")
		Cutting Height	20 - 75 mm (13/16 - 2-15/16")
		No Load Speed (RPM)	4,300
	Soft Start	Wheel Size	Front / Rear: 140 / 180 mm (5-1/2 / 7-1/8")
		Actual Mowing Area*	w / BL1840B: 270 m ²
		Continuous run time*	w / BL1840B: 14 min
		Sound Pressure Level	82.4 dB(A)
		Sound Power Level	89.0 dB(A)
		Vibration Level	2.5 m/s ² or less
		Dimensions (L x W x H)	During Operation: 1,285 - 1,350 x 375 x 935 - 975 mm (50-1/2 - 53 x 14-3/4 x 36-3/4 - 38-3/8")
			When Stored (w/o Grass Box): 520 x 375 x 775 mm (20-1/2 x 14-3/4 x 30-1/2")
		Net weight	11.6 - 12.5 kg (25.6 - 27.6 lbs.)
			*on a full battery charge

Standard Equipment : Blade, Mulch Plug, Wrench, Battery, Charger

The weight may differ depending on the attachment(s), including the battery cartridge. The lightest and heaviest combination, according to EPTA-Procedure 01/2014, are shown in the table. Items of standard equipment and specifications may vary by country or area.

Makita Corporation

3-11-8 Sumiyoshi-cho, Anjo, Aichi, 446-8502 Japan

PRINTED IN JAPAN 202112